



Multipurpose

- ARCHI 390
- ARCHI 450



Interceptor

- RBB 470 - 660
- RBB 850
- RBB 1200
- RDBB 850
- RDBB 1200

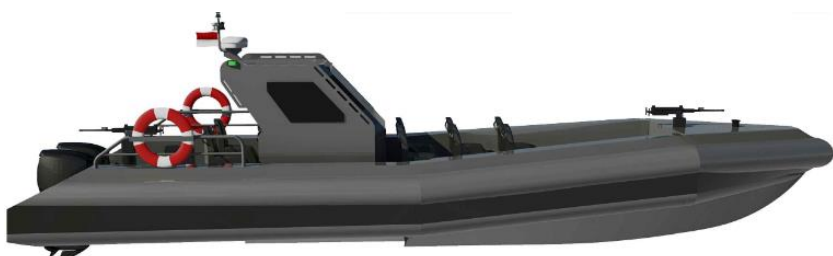

Patrol

- RDBB 850
- RDBB 1200
- RDBB Bullet Proof Armored



Passenger

- ASCAT 900
- ASCAT 1200
- House Boat



Utility Platform

- Hydro Jack
- Boat Landing Platform

ADVANTAGES OF HDPE BOAT



LOW MAINTANENCE



UNSINKABLE



NO CORROSION



FLEXIBLE DESIGN



IMPACT RESISTANCE



RECYCLABLE



MARINE GROWTH
RESISTANCE



UV RESISTANCE

HDPE [High Density Polyethylene] is a firm and strong derivative of hydrocarbon. Unlike other Polyethylene, **HDPE is heavy and firm. HDPE is lighter than water (0.96 T/m³), durable** (up to 50 years), **eco-friendly, corrosion free**, and requires very **little maintenance**. HDPE Boat is easier to be repaired, can be welded with special method. HDPE mechanical specifications are **very good especially on impact and tension**. Therefore, HDPE becomes a **preferred material for marine purposes**.

Applications	Fiberglass	Alumunium	HDPE
Impact Resistance	Poor	Good	Excellent
Repair Ablility	Good	Good	Excellent
Mass	Average	Heavy	Light
General Abuse Resistance	Poor	Poor	Excellent
UV Resistance	Poor	Excelllent	Excellent
Maintenance Requirement	High	High	Low
Sandy Beach landing	Good	Good	Good
Rocky Beach Landing	Good	Poor	Excellent
Puncture Resistance	Poor	Good	Excellent



Principal Particular						
Type	Length (Meter)	Width (Meter)	Est. Weight (Kg)	Pass. (Pax)	Max Cap (Kg)	Engine (HP)
470	4.70	2.07	650	4	800	1 x 115 HP
670	6.70	2.50	950	6-7	1,250	2 x 115 HP
850	8.50	3.00	1,375	8-10	2,000	2 x 200 HP
1200	12.00	3.20	2,130	14-16	2,600	2 x 300 HP

Standard Equipment

Hull Manufactured from **HDPE**
 4 Lifting Bolts
 Bow Store & Hatch Cover
 Driver & Passenger Seats
 Electric Bilge Pump
 Electric Control Switch Housing
 Engine Oil & Battery Console

Compass
 Heavy Duty Rubbing Strakes
 Heavy Duty Side Handles
 Hydraulic Steering System
 Navigation Lights
 Fire extinguisher
 Navigation Stainless steel frame



Principal Particular

Type	Length (Meter)	Width (Meter)	Est. Weight (Kg)	Pass (Pax)	Displacement (Kg)	Engine (HP)
750	7.50	3.00	1,870	7-8	3,600	2 x 200 HP
850	8.50	3.00	2,000	8 - 10	3,800	2 x 200 HP
1150	11.50	3.10	2,980	12-14	5,000	2 x 250 HP
1200	12.00	3.30	3,088	14-16	5,280	2 x 300 HP

Standard Equipment

- Hull Manufactured from **HDPE**
- 4 Lifting Bolts
- Bow Store & Hatch Cover
- Compass
- Driver & Passenger Seats
- Electric Bilge Pump
- Electric Control Switch Housing
- Engine Oil & Battery Console

- Navigation Stainless steel frame
- Heavy Duty Rubbing Strakes
- Heavy Duty Side Handles
- Hydraulic Steering System
- Navigation Lights
- Fire extinguisher

RDBB (Rigid Double Buoyancy Boat) has a double buoyancy pontoons, making this ship has a **higher buoyancy and more rigid**. Suitable for extreme weather conditions.





PATROL BOAT WITH CABIN



Rigid Buoyancy Boat (RBB) : 8.50 M

PRINCIPAL DIMENSION

Length Overall (L_{OA})	:	8.50 M
Length Waterline (L_{WL})	:	7.15 M
Breadth Maximum (B_{max})	:	3.00 M
Draft Design (T)	:	0.50 M
Passenger	:	8 Pax
Fuel Tank Capacity	:	500 Liters
Boat Weight	:	2,100 Kg
Max Capacity	:	3,500 Kg
Power Engine	:	2x150 HP
Material	:	HDPE



PATROL BOAT BULLETPROOF ARMORED



Bulletproof Armored Patrol Boat

PRINCIPAL DIMENSION

Length Overall (L _{OA})	: 12.00 M
Length Waterline (L _{WL})	: 7.15 M
Breadth Maximum (B _{max})	: 3.30 M
Draft Design (T)	: 0.55 M
Passenger	: 14 Pax
Fuel Tank Capacity	: 600 Liters
Boat Weight	: 4,570 Kg
Max Capacity	: 6200 Kg
Power Engine	: 2x300 HP
Material	: HDPE

STANDART EQUIPMENTS

- 4 Lifting Hook
- Bow Store & Hatch Cover
- GPS
- Radar
- Radio
- Search Light
- Compass
- Driver & Passenger Seats
- Electric Bilge Pump
- Electric Control Switch Housing
- Engine Oil & Battery Console
- Fuel Tank
- Heavy Duty Internal Handle
- Heavy Duty Side Handle
- Hydraulic Steering System
- Navigation Lights
- Navigation Stainless Frame
- Non-Slip Deck
- Boat Cover
- Bolder & Side Fender
- Bulletproof Cabin



Watercraft



Archi Seri 390

Length Overall	: 3.90 M
Breadth	: 1.85 M
Dry Weight	: 330 Kg
Displacement	: 650 Kg
Engine	: 30 HP
Passenger	: 2 Pax
Hull Material	: HDPE

Archi Seri 450

Length Overall	: 4.50 M
Breadth	: 1.96 M
Dry Weight	: 420 Kg
Displacement	: 1000 Kg
Engine	: 40 HP
Passenger	: 4 Pax
Hull Material	: HDPE



ASYMMETRIC CATAMARAN

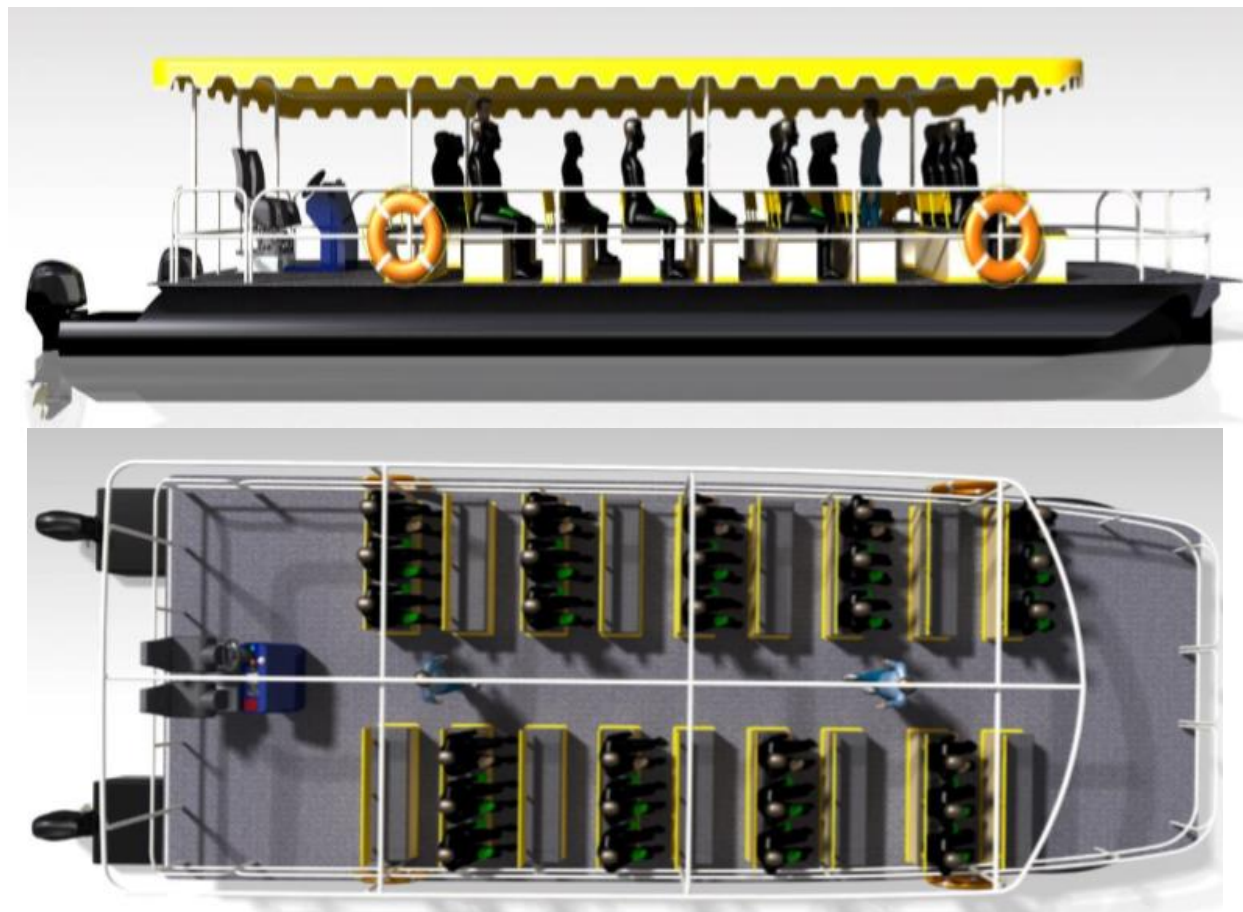

Principal Particulars

- Hull Manufactured from **HDPE**
- LOA: 12.64 m
- Width: 4.60 m
- Draft: 0.57 m
- Dry weight : 3.7 t
- Max. Displacement: 9.1 t
- Max. Speed: 8 knots

Capacity

- Passengers: 54 pax
- Crew: 2 pax

Propulsion/Power Storage

- Engine: Diesel/Petrol OBM 2x25 HP



HOUSE BOAT

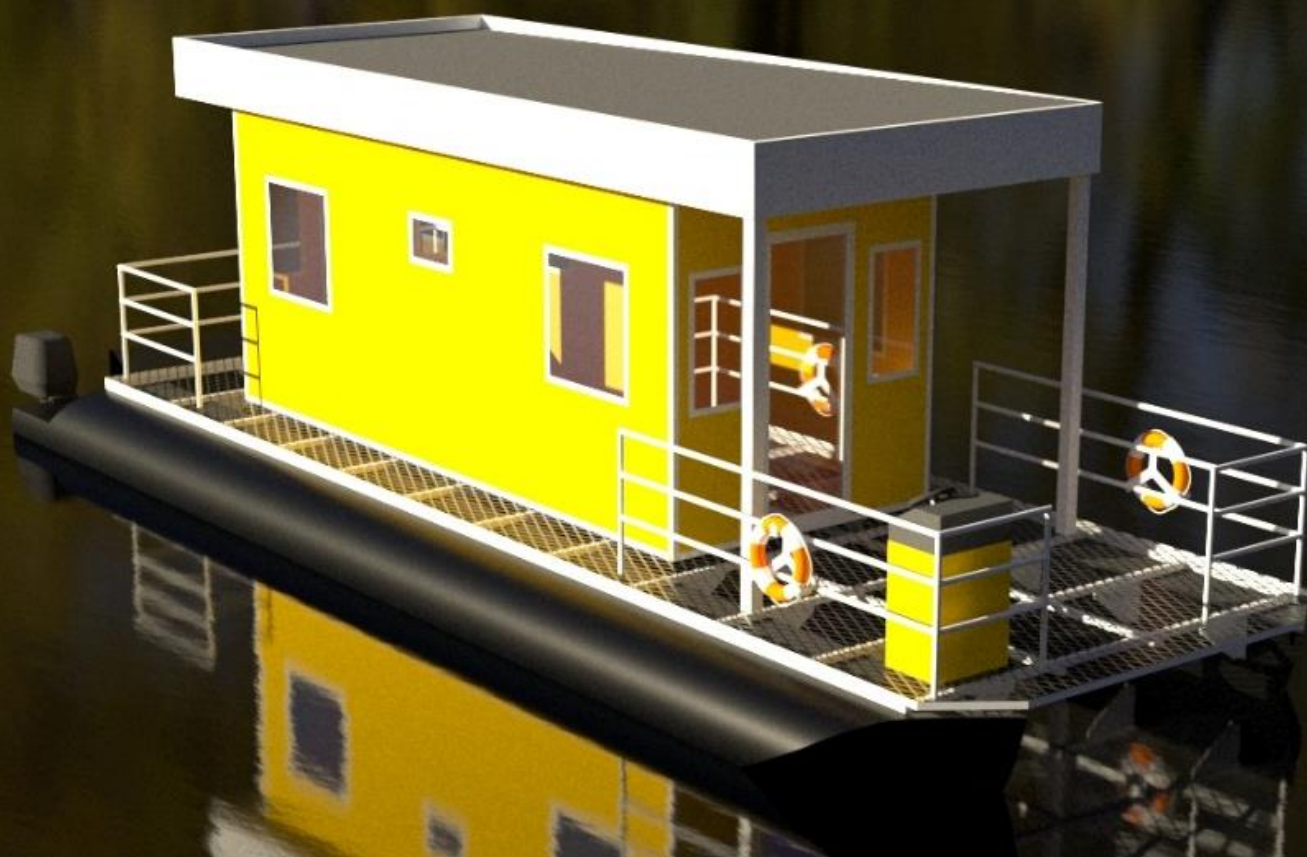

Principal Particulars

- Pontoon Manufactured from **HDPE**
- Length Over All : 12.00 m
- Width : 4.50 m
- Design Draft : 0.57 m
- Dry weight : 5.400 Ton
- Max. Displacement : 9.100 Ton
- Max. Speed : 7 knots
- House Area (LxBxH) : 6.00 m x 2.40 m x 3.00 m

Propulsion & Power Supply

- Engine: Diesel/Petrol OBM 2x25 HP
- Power Source : Generator



HYDRO JACK

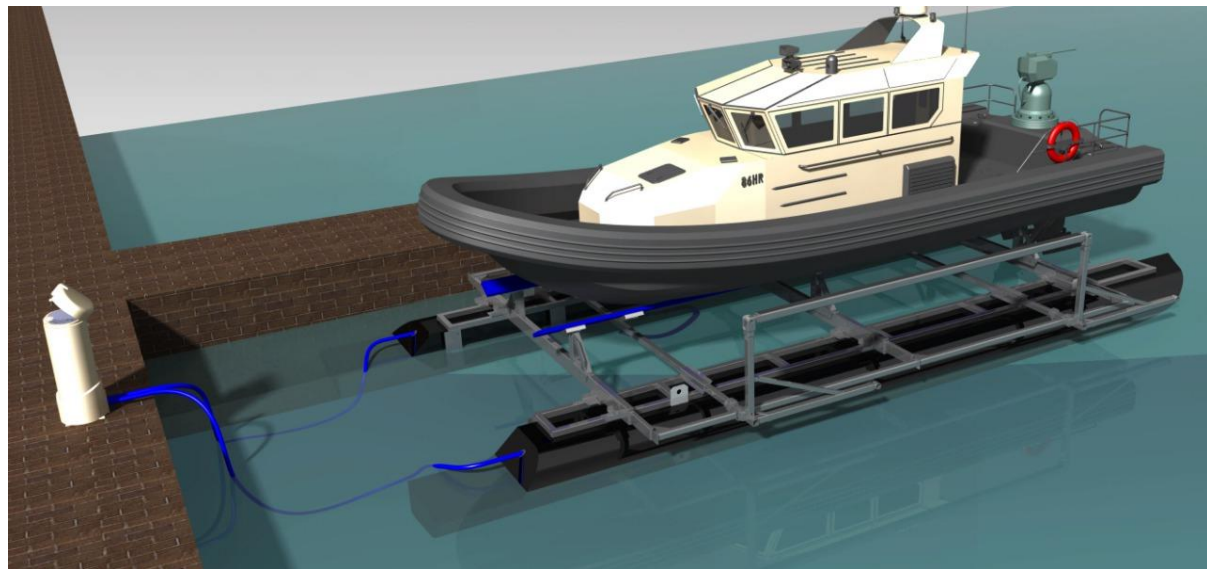
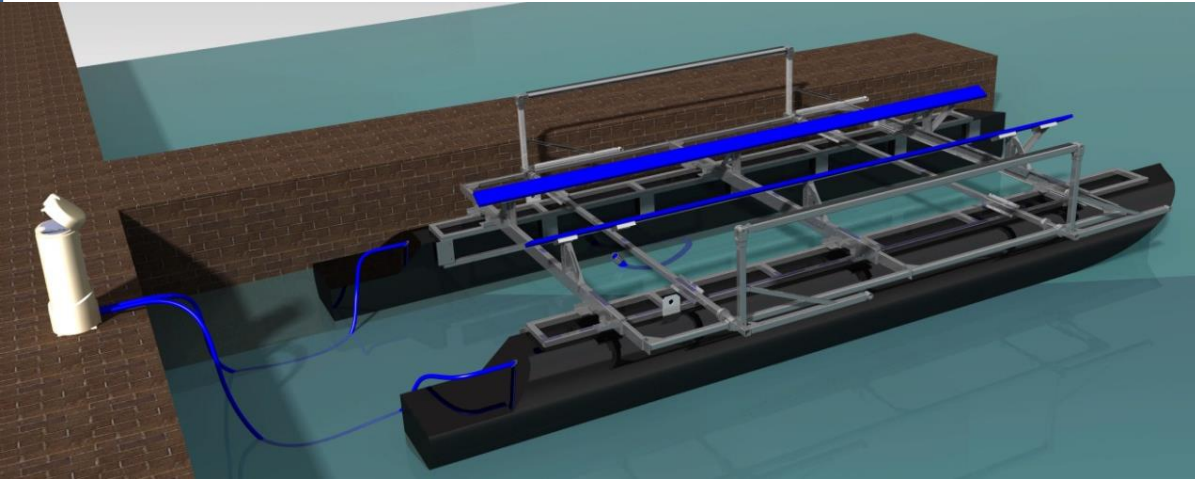

Principal Particular

Type	: FHJ3000
Length	: 7.5 m
Width	: 3.5 m
Max. Draft	: 0.55 m
Capacity	: Up to 3,000 Kg (<i>*Custom design by required up to 12,000 Kg</i>)

Operation Time

Up Lift	: 3.6 Minutes
Down Lift	: 7 minutes

Power Supply Generator with minimum 3000 Watt or Government Electric (PLN) 3000 Watt



BOAT LANDING PLATFORM



Specification

Type	: FLB3510
Length	: 10 m
Width	: 3.5 m
Capacity	: Up to 3000 Kg
Docking Time	: 5 minutes

*Size and capacity are customizable as client's request

Power Supply

Generator with minimum 2000 Watt or Government Electric (PLN)
2000 Watt

CUSTOMIZATION

Floaton boat provides customization services based on the basic design series that we have to adjust its functionality aspects in order to accommodate customer needs.



MAINTENANCE

Floaton Boat provides after-sales preventive maintenance and repair services.

